

**FIRST FLOOR  
PLANT ROOM**

**BIRMINGHAM GREAT PARK  
GALA CLUBS LTD.  
GROUND FLOOR PLAN AS PROPOSED**

**LEISURE SITE No:6/7  
LEISURE UNIT**  
Site Area : 8,630sq.m. (92,894sq.ft.)

GROUND FLOOR-Gross Internal Floor Area	: 2368sq.m.
GROUND FLOOR-Gross Internal Floor Area	: 25,489sq.ft
MEZZ. FLOOR-Gross Internal Floor Area	: 756.5sq m
MEZZ. FLOOR-Gross Internal Floor Area	: 8,125sq.ft
PLANT ROOM-Gross Internal Floor Area	: 67 sq.m.
PLANT ROOM-Gross Internal Floor Area	: 721sq.ft

The concrete slab will be chased in the fit out contract to every table position - floor slab to be thick enough and have re-inforcement towards the bottom of the slab not at the top-engineer to allow for this in his design

- Notes:
1. Do not scale the drawings
  2. All sites to be checked
  3. The electrical installation to be checked to the latest edition of the I.E.E.
  4. The following materials / workmanship to be to the complete satisfaction of the local authority
  5. The following materials / workmanship to be to the complete satisfaction of the local authority
  6. High alumina cement is to be used for all concrete work
  7. Wood work shall be painted with a suitable preservative
  8. Coloured concrete to be used for all concrete work
  9. Cast-in-situ concrete to be used for all concrete work
  10. Aggregates for use in concrete to be of British Standard Specification
  11. Aggregates for use in concrete to be of British Standard Specification
  12. Aggregates for use in concrete to be of British Standard Specification
  13. Aggregates for use in concrete to be of British Standard Specification
  14. Aggregates for use in concrete to be of British Standard Specification
  15. Aggregates for use in concrete to be of British Standard Specification
  16. Aggregates for use in concrete to be of British Standard Specification
  17. Aggregates for use in concrete to be of British Standard Specification
  18. Aggregates for use in concrete to be of British Standard Specification
  19. Aggregates for use in concrete to be of British Standard Specification
  20. Aggregates for use in concrete to be of British Standard Specification
  21. Aggregates for use in concrete to be of British Standard Specification
  22. Aggregates for use in concrete to be of British Standard Specification
  23. Aggregates for use in concrete to be of British Standard Specification
  24. Aggregates for use in concrete to be of British Standard Specification
  25. Aggregates for use in concrete to be of British Standard Specification
  26. Aggregates for use in concrete to be of British Standard Specification
  27. Aggregates for use in concrete to be of British Standard Specification
  28. Aggregates for use in concrete to be of British Standard Specification
  29. Aggregates for use in concrete to be of British Standard Specification
  30. Aggregates for use in concrete to be of British Standard Specification
  31. Aggregates for use in concrete to be of British Standard Specification
  32. Aggregates for use in concrete to be of British Standard Specification
  33. Aggregates for use in concrete to be of British Standard Specification
  34. Aggregates for use in concrete to be of British Standard Specification
  35. Aggregates for use in concrete to be of British Standard Specification
  36. Aggregates for use in concrete to be of British Standard Specification
  37. Aggregates for use in concrete to be of British Standard Specification
  38. Aggregates for use in concrete to be of British Standard Specification
  39. Aggregates for use in concrete to be of British Standard Specification
  40. Aggregates for use in concrete to be of British Standard Specification
  41. Aggregates for use in concrete to be of British Standard Specification
  42. Aggregates for use in concrete to be of British Standard Specification
  43. Aggregates for use in concrete to be of British Standard Specification
  44. Aggregates for use in concrete to be of British Standard Specification
  45. Aggregates for use in concrete to be of British Standard Specification
  46. Aggregates for use in concrete to be of British Standard Specification
  47. Aggregates for use in concrete to be of British Standard Specification
  48. Aggregates for use in concrete to be of British Standard Specification
  49. Aggregates for use in concrete to be of British Standard Specification
  50. Aggregates for use in concrete to be of British Standard Specification

fixed bingo seating	1139
loose seating	0200
disabled spaces	0011
<b>GROUND FLOOR SEATS</b>	<b>- 1450</b>
fixed bingo seating	0130
loose seating	0114
disabled spaces	0006
<b>MEZZ ANINE FLOOR SEATS</b>	<b>- 250</b>
<b>TOTAL SEATING</b>	<b>-----1700</b>
<b>50 awp machines</b>	

- AFFF -> dry powder fire extinguisher
- Co2 -> fire extinguisher Carbon dioxide
- fire panel
- FB -> fire blanket

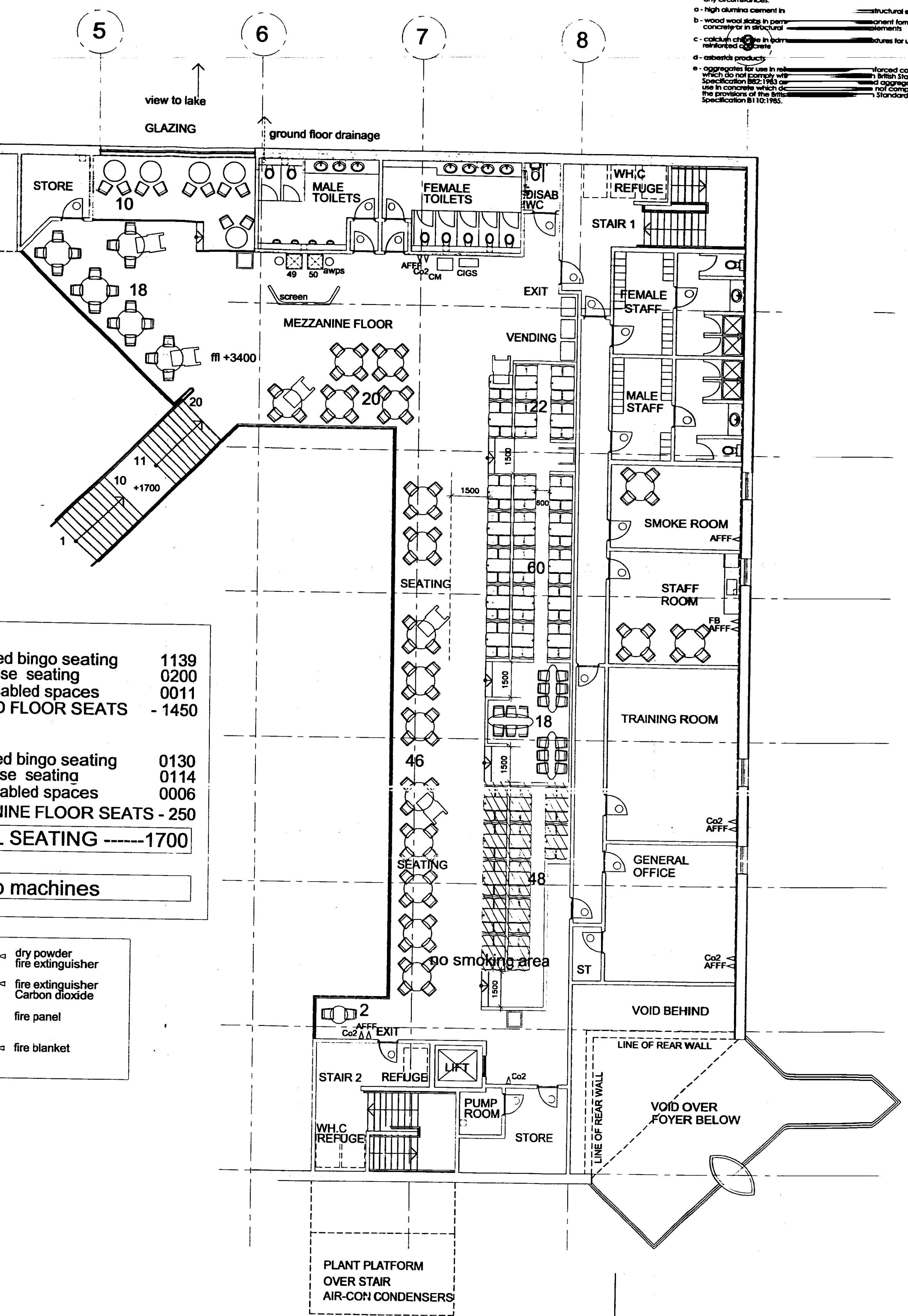

**MEZZANINE FLOOR PLAN**

REV N-TENDER ISSUE MAY00 AM

REVISIONS

**TENDER**

Proposed Leisure Development at BIRMINGHAM GREAT PARK for... CORPORATE LAND BINGO & SOCIAL CLUB LEISURE SITE 6/7

2018/003

DRAWN BY: MUNDELL CHECKED BY: [Signature]

SCALE: 1:100 DATE: [Signature]

UNICK ARCHITECTS LIMITED  
 4 PARK GATE  
 GLASGOW G3 6LJ  
 TEL: 0141 332 4234  
 FAX: 0141 332 4236  
 E-mail: unick@unick.co.uk